

Manual

Power Generator

Applies for:

Codes	Models
26035	GEN-55P
26036	GEN-70P

GEN-55P

6 600 W

Maximum starting power

5 500 W

Rated power

GEN-70P

8 000 W

Maximum starting power

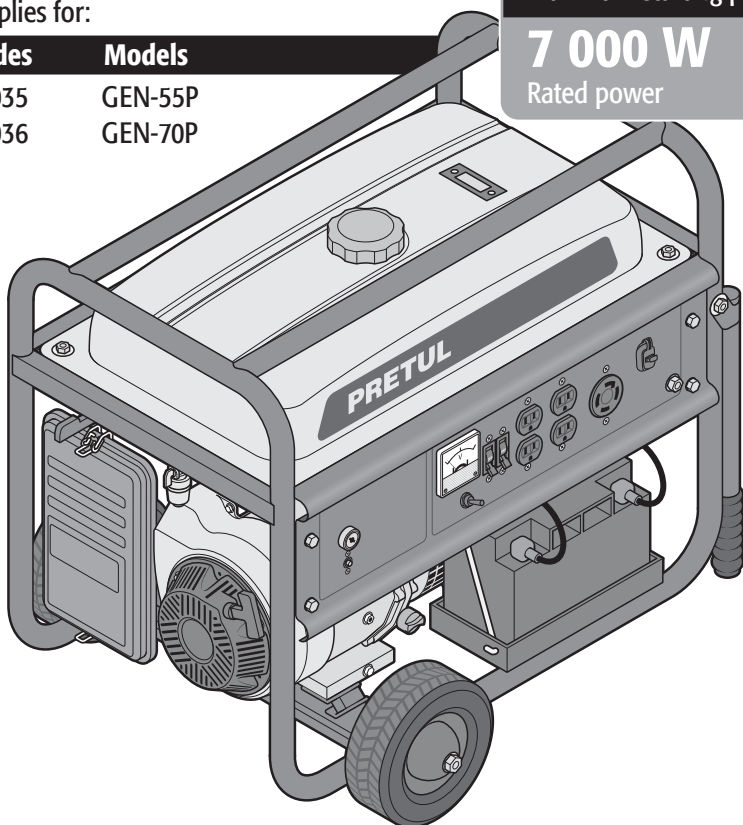

7 000 W

Rated power



Read this manual thoroughly
before using the tool.



Technical Data	3
Fuel Requirements	3
Electric Diagram	3
 General Safety Warnings for Power Generators	4
 Safety Warnings for the Use of Power Generators	5
Parts	6
Assembly	7
Fuel and Oil	8
Startup	9
Maintenance	10
Accessories and replacement parts	12
Troubleshooting	13
Authorized Service Centers	14
Warranty Policy	15

CAUTION

To gain the best performance of the tool, prolong the duty life, make the Warranty valid if necessary, and to avoid hazards of fatal injuries please read and understand this Manual before using the tool.

Keep this manual for future references.

The illustrations in this manual are for reference only. They might be different from the real tool.

Use and care recommendations



DO NOT START the machine **WITHOUT OIL** or the engine will suffer serious damage due to lack of lubrication.



For better performance and durability use higher-octane gasoline. In Mexico, we suggest using **PREMIUM** gasoline. Never use gasoline that is contaminated and/or mixed with additives or oils.



DO NOT connect devices that exceed the **MAXIMUM OPERATING POWER**.



Position the generator on a **STABLE AND FLAT SURFACE**.



DO NOT OPERATE THE GENERATOR IN RAINY OR HUMID CONDITIONS, and refrain from using the machine with wet hands.



Perform regular **MAINTENANCE** on your machine (page 10).

PRETUL

GEN-70P

Fuel Requirements

- The generator is built with an air-cooled, 4-stroke motor using unleaded pure gasoline.
- For no reason at all mix oil with the fuel.

⚠ WARNING • For no reason at all use fuel mixed with ethyl alcohol (gasohol), ethanol, or methanol. These attract humidity causing separation and acid build-up while stored. Acidity may damage the motor fuel system when stored.

- To prevent issues with the motor, empty the fuel system before storing the generator during 30 days or longer periods of time. Empty the gasoline tank, start the motor and leave it running until the fuel and carburetor lines are empty. The next season, use fresh gasoline.
- Never pour into the gasoline tank, motor or carburetor cleaning liquids because it can result in permanent damage.

Electric Diagram

[illegible][illegible]



WARNING! Read carefully all the safety warnings and all the instructions listed. Failure to observe these warnings may result in electric shock, fire and / or severe injuries. **Save the warnings and instructions for future reference.**

Work Area

Keep your work area clean, tidy and well lit.

Cluttered and dark areas may cause accidents.



Never use the tool in explosive areas such as in the presence of flammable liquids, gas or flammable dust.

Power tools produce sparks which may light up flammable materials.



Keep children and passersby at a safe distance while operating the tool.

Distractions can cause losing control.



Operate the generator ONLY outdoors.

Do not operate the generator in closed spaces. The generator produces carbon monoxide: an odorless highly toxic gas. Breathing the gas produce nausea, fainting or even death.



Electric Safety

Plugs shall match the generator power outlets.

Never modify a plug. Do not use adaptors for ground plugs.



Modified plugs and different power outlets increase the risk of electric shock.

Avoid body contact with grounded surfaces like pipes, radiators, electric ranges and refrigerators.

There is a higher risk of electric shock if the body gets grounded.

Do not use the generator under rain or humidity conditions.

Water increases the risk of an electric shock.

Do not handle the generator or electric cables while standing on water, barefoot or with wet hands and feet.

Water increases the risk of an electric shock.

Do not use any equipment if cables are worn, broken, peeled, or entangled in any way.

Damaged or entangled cables increase the risk of electric shock.

Use only rubber-covered flexible extension cables (in accordance with IEC 245 – 4) or equivalent.

Using an inadequate extension increases the risk of electric shock.

Personal Safety

Stay alert! Watch what you are doing and use common sense when using a tool. Refrain from using the tool if tired or under the influence of drugs, alcohol or medication.

Being momentarily distracted while using the tool could cause severe personal injury.

Wear protective safety accessories.

Wearing eye protection, insulated safety shoes and gloves, helmet and ear plugs in noise conditions higher than 85 dB reduce significantly personal injuries.



Prevent an accidental startup. Disconnect all the tools from the generator before starting.

Unsupervised power tools with the switch in the ON position may cause accidents.

Remove brackets or adjusting tools before starting the generator.

Additional tools or vices installed in a rotating part in the generator could damage the equipment or cause severe personal injuries to the operator.

Do not overreach. Keep both feet perfectly set on the ground and keep good balance at all times.

These measures lead to better controlling the tool in unexpected situations.

Wear proper clothes.

Do not wear loose clothes or jewelry.

Keep your hair, clothes and gloves away from moving parts.

Loose clothes, jewelry or long hair may get caught in the mobile parts.



Do not touch the exhaust while the generator is running.

Temperature in the muffler and nearby areas may go over 150 °F (65 °C). To prevent burns, allow the motor to cool down before manipulating or storing the generator.

Use and Care of the Generator

Do not force the generator. Use it within the range it was designed for. Assume a safe and efficient job.

Do not use any attachment to increase the generator capacity.



Connect only adequate power tools.

Do not use power tools for heavy duty work to which the tool is not designed for.

Do not use power tools if the switch is not working.

Any power tool that cannot be turned IN or OFF is dangerous and shall be repaired immediately before using.

Turn OFF the generator and wait until the motor is cooled down before carrying out any type of adjustment, changing accessories or storing.

To reduce the risk of burns or accidentally starting it up.

Store the generator when not in use and away from children's reach. Do not allow untrained people operate the generator.

The generator can be dangerous under untrained hands.



Carry out maintenance to the equipment. Double check the mobile parts are not misaligned or stuck. No broken parts or other conditions affecting its operation shall be present. Repair any damage before using the generator.

Most accidents are caused by lack of maintenance.



Keep tools in the best conditions.

Connect to the generator only tools in optimum conditions to guarantee a good job and a safe operation.

Use the generator, its components and accessories in accordance with these instructions and the manner foreseen for the type of job in the right conditions.

Using the tool for applications different to which is designed could cause a dangerous situation.

Service

Repair the tool in a TRUPER Authorized Service Center using only identical spare parts.

To keep the tool safety.

Safety Warnings for power Generators

PRETUL

Electricity Handling

⚠ WARNING • Electric generators produce tension that could be dangerous. If the generator is not insulated from other electric installations, people using them may be severely injured or die due to an electric shock. ⚡

⚠ WARNING • The generator shall not be connected to other energy sources, such as the power supply company. Under emergency when is strictly necessary to be connected to those energy sources, only a certified electrician shall carry out connections taking into account the differences between the power supply and the generator technical specifications.

⚠ CAUTION • Protection against electric shock depends on the circuit breakers are specially homogenized for the generator. If the circuit breakers must be replaced, go to a TRUPER Authorized Service Center.

⚠ CAUTION • Alternate current connections within the electric system shall be carried out by a certified electrician complying with the applicable electric standards or codes.

⚠ WARNING • Inadequate connections may generate an electric discharge towards the outlet lines. It can electrocute the consumers using the electric circuits and even third parties that could touch the lines during a blackout. When electricity is restored, the generator could explode, burn or cause fires. ⚡

• Ground the generator properly before starting up.
• The generator can produce energy and work safely within the following conditions: altitude lower than 4920 ft, in ambient temperature between 41 °F and 104 °F and with 90% relative humidity.

Fuel Handling

• Never smoke neither close to the generator nor in the gasoline supply zone or when operating the generator. ⚡

• To reduce the risk of fire or burns handle fuel with care. It is extremely flammable. ⚡

• Do not allow gasoline or oil making contact with your skin.

• Protect your eyes to prevent gasoline and oil spills. In the event of accidental contact, wash immediately with clean water. If irritation persist, go to a physician.

• Store fuel in a container specially designed for that purpose.

⚠ WARNING • Before refueling the generator, turn OFF the motor, set it in clear ground and wait for the motor to cool down.

⚠ CAUTION • Wipe clean all the fuel spilled on the generator before operating.

⚠ CAUTION • Double check for fuel leaks. If that is the case, correct the leaks before using the generator to prevent fire or injuries by burns.

• Under no circumstance burn spilled fuel to eliminate it.
• For no reason at all use any other type of fuel than the one specified in the Manual.

Before Operating the Generator

⚠ CAUTION • Teach yourself to quickly turn OFF the generator. Learn the function of all the controls.

• To adequately ventilate the generator, keep at least 2 feet free space around the generator.

• Set the generator in a firm and leveled surface: avoid sandy or snowed surfaces. If the generator overturns or tilts, fuel could spill out or dust or water could enter into the equipment.

• Do not connect any device OFF. Connect the devices after setting them ON.

• In the event of any difficulty or you have questions about the generator, see a TRUPER Authorized Service Center.

Electric generators made with one-cylinder, air-cooled gasoline motor are a portable electric energy source for recreational use (travel or camping), for emergencies (during blackouts) or for domestic use (out of range of the power company).

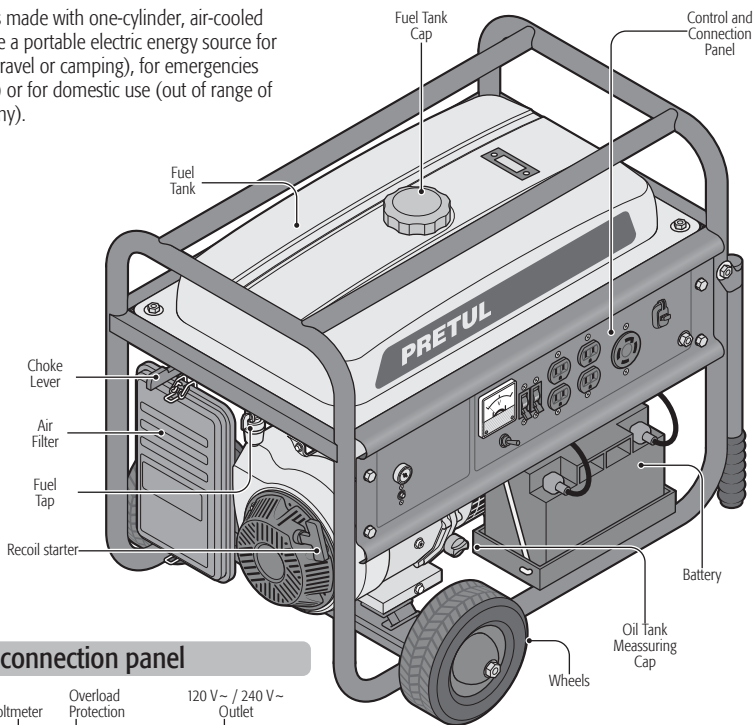

Control and connection panel

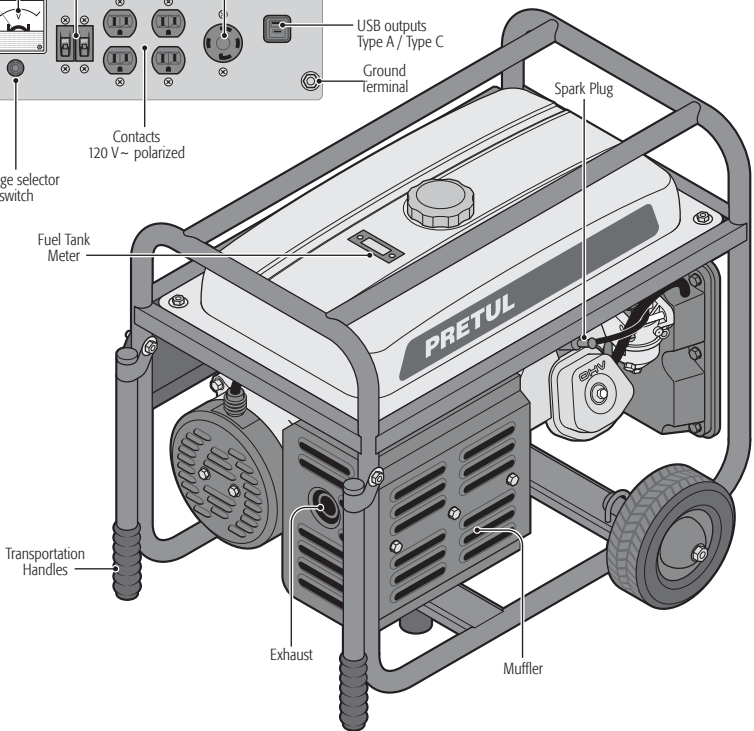
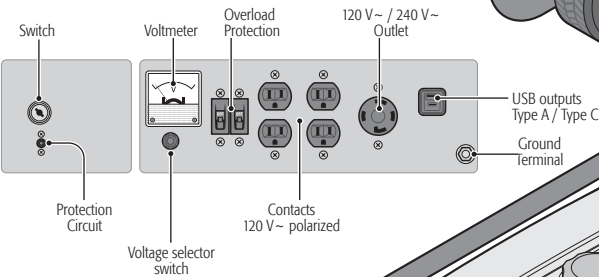

- Before operating, assemble the generator completely as indicated below.
- Position the generator on a stable and level surface so that it rests on one of its sides.

1. Wheel axle shaft assembly. Press the axle shaft lock while inserting it through the bracket located on the chassis.

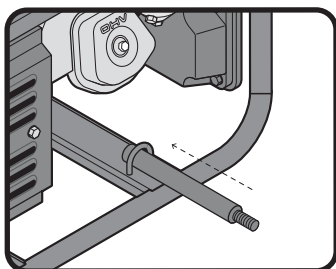

2. Place the wheel on the axle and secure the assembly with a set of washers (flat and lock washers) and the nut.

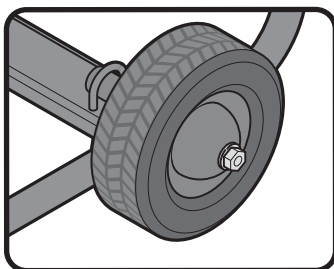

3. Align the holes on the chassis to fit the metal bracket, then secure it using the two screws and nuts.

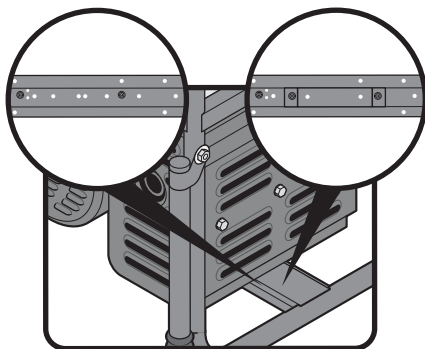

4. Assemble the rubber support on the bottom of the metal bracket and secure it with the included nut.

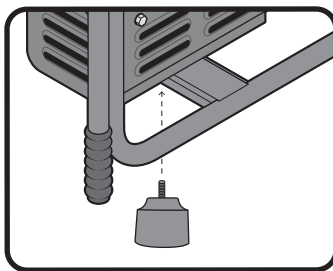

5. Finally, attach the carrying handles to the sides of your generator (exhaust side) and secure with a set of plastic washers and the screw with nut as shown in the image. Make sure to assemble the handles and the two wheels correctly.

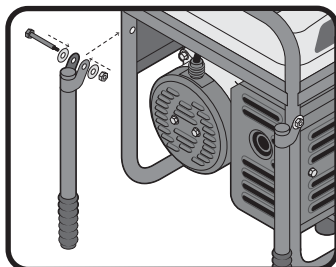

Oil Supply (A)

- Set the generator in a flat and level surface.
- Turn and remove the oil tank cap.
- Fill up the tank with 4-stroke gasoline motor oil SAE 10W-30. Use a funnel.
- Set back the cap and remove to check the oil level in the cap oil measuring rod.
- Once the tank reached the right level indicated in the rod. Tighten the cap to prevent leaks.

⚠ CAUTION • Do not exceed the maximum oil level because it may produce a lot of smoke when starting the motor.

⚠ CAUTION • Check oil level before each use. If necessary, add oil until the level is within the limits in the cap oil measuring rod.

⚠ CAUTION • Change the oil for the first time after 20 hours of use, and then perform subsequent changes every 100 hours. In very dusty or dirty conditions, it may be necessary to change oil more often.

Fuel Supply (B)

- Set the generator in a flat, leveled surface.
- Clean and dry the area around the fuel cap.
- Remove the fuel cap.
- Using a funnel, slowly fill up the fuel tank up to the lower part of the tank neck. Do not overfill to allow fuel expansion and prevent spills.
- Clean any fuel spills.
- Cover the tank turning the cap until hearing a click.
- Clean all the fuel spills before starting the motor.

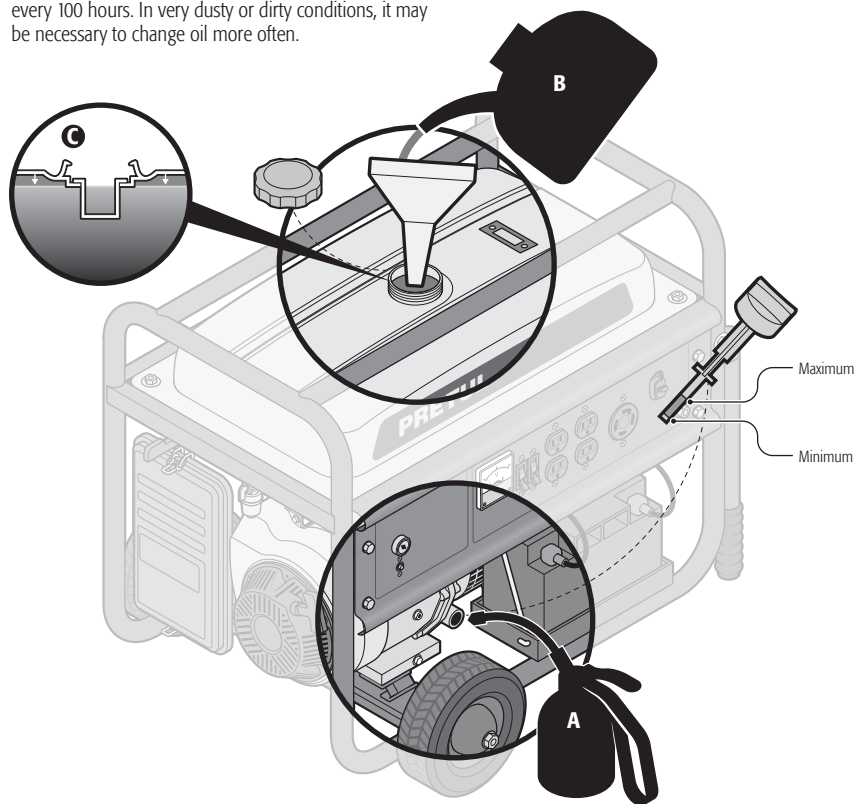

Start the Motor

- Ground the generator. Disconnect all the devices from the connection panel (A) and double check the switch and breakers are OFF.
- Make sure the fuel tap (B) is open.
- Set the choke lever (C) into the **OFF** position.
- Insert the switch key (D) and turn into the **START** position.
- Once the machine is **ON**, turn the switch into the **ON** position.

Starting with the jack-line:

- Insert the switch key and turn into open position (**ON**).
- Gently pull the jack-line (E) until feeling resistance in the line. Then pull with force to start the motor.
- Once is **ON**, set the choke lever (C) into the open position (**ON**).

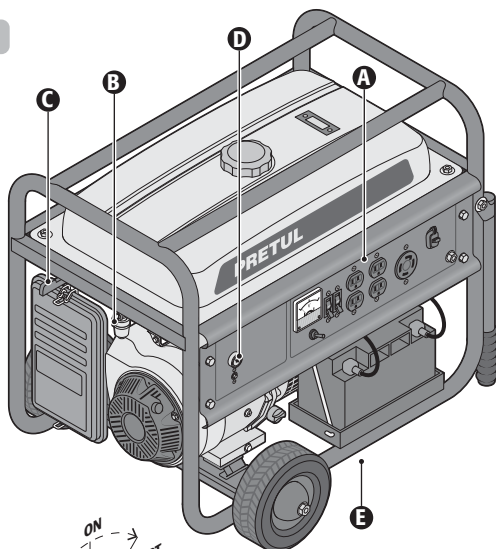

Connecting Devices

- After starting the generator, turn **ON** the overload protector.
- Connect the desired devices (F) to the outlets on the connection panel.

CAUTION If connecting more than one device, connect first those using a higher current to start.

CAUTION Verify the devices do not exceed longer than 30 minutes' the rated current of the generator and that never exceed the maximum output load.

- Turn **ON** the switch and the breakers.

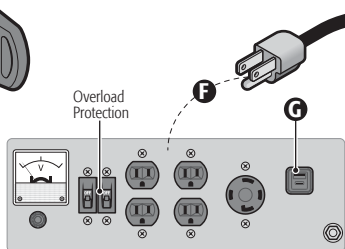
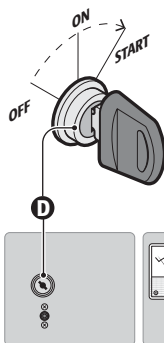

Overload

CAUTION • If there is an important overload, the overload protector will turn OFF. It is possible that a marginal overload will not turn OFF the thermal protection but will reduce the useful life of the generator.

CAUTION • If the overload protector is OFF because a circuit is overloaded, reduce the electric charge of the circuit and wait a couple of minutes before restarting the overload protector.

Turning OFF

- Put the overload switch into the **OFF** position (A).
- Close the fuel tap (B).
- Set the switch (C) into the **OFF** position.
- Disconnect all the devices from the connection panel.
- ⚠ CAUTION** • If the generator needs to be shut down urgently due to an emergency, it can be done in one step by placing switch (C) into the **OFF** position.

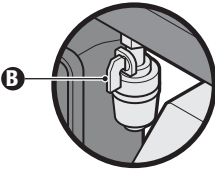
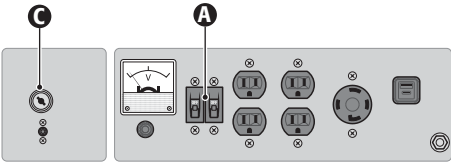

Operating in High Altitude

- In high altitudes, the amount of fuel in the carburetor mix increase, performance is lower and fuel consumption is higher.
- Even though the carburetor injection is adequate, the motor power is lower by 3.5% per each 1 000 feet above 6890 feet above sea level. The decrease in power will be more drastic if no adjustments to the carburetor are carried out. Consult a TRUPER Authorized Service Center to make the adjustments.

Maintenance

- ⚠ CAUTION** • Regular and careful maintenance is essential to keep the generator at optimal security and performance levels.
- Before cleaning, repairing, inspecting or storing the generator, turn **OFF** the motor and wait until the motor has completely cooled down.
- Keep all the nuts, bolts and screws adjusted to assure the generator is in a safe working condition.

- Do not modify the safety devices. Verify regularly to ensure proper operation.
- Any worn or damaged part shall be replaced before using the generator. Do not try to repair parts. The generator can get damaged and put your safety at risk.
- Any repairs or maintenance different to those described in this section, for example, adjusting the carburetor, shall only be carried out in a TRUPER Authorized Service Center.

Periodic Maintenance	Before each use	Each 20 h or each month	Each 50 h or 3 months	Each 100 h or 6 months	Each 300 h or each year
General inspection	Carry out				
Motor oil	Check	Replace*		Replace	
Air filter	Check		Clean	Replace	
Sediment container				Clean	
Spark plug				Clean / Readjust	
Valve clearance		Check / Readjust (2)			Check / Readjust (2)
Fuel tank and strainer					Clean (2)
Fuel line		Check and change if necessary, each 3 years (2)			
Fuel tank cap				Clean	

1. If the generator is operating in very dusty environments, carry out maintenance more frequently.
2. Go to a TRUPER Authorized Service Center to carry out this service.
*This only applies to the first oil change.

Air Filter

- Check the air filter to assure is in good conditions. Remember, a dirty filter could cause startup issues, loss of performance and shorten the useful life of the motor.
 - Remove the air filter cover releasing the locks (A).
 - Wash the filter with a hot water and detergent solution. Allow the filter to dry completely.
 - Soak the filter in clean SAE 10W-30 motor oil. Squeeze until eliminating the excessive oil. The motor might release smoke during startup if there is too much oil in the filter.
 - Install the filter in its container and set the cover back in.
- CAUTION** Never use gasoline to clean the air filter. It could cause a fire or explosion. Never start the generator with no air filter in place. The motor wears out faster.

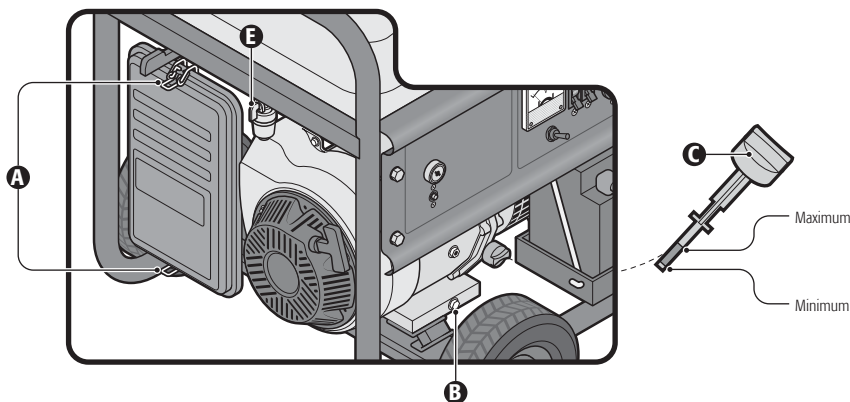

Oil Change

- The oil drain cap is set under the motor (B).
- Set an adequate container under the generator to get the oil. Remove the drain cap and then, the tank cap (C). Once the oil is drained, set back the drain cap.
- Clean any spills or splashes.
- Fill up the tank with SAE 10W-30 oil.
- Check oil level setting the oil tank cap without screwing it. Oil level shall be between the *minimum* and *maximum* level in the oil measuring rod. Make sure the level is not exceeding the *maximum* mark. Tighten the tank cap when the level is adequate.
- Start the motor and leave it running briefly. Stop the motor. Wait one minute and check the oil level again. Refill if necessary.
- For no reason at all pour used oil in the drain! Take the used oil to a recycling unit.

Fuel Filter

- The fuel filter prevents water or dust from the fuel tank from entering the carburetor. If the motor has not been started after a long period of time, the sediment container needs to be cleaned:
- With the motor **OFF** and ambient temperature, close the fuel tap (E).
- Remove the sediment container (F). Clean the interior together with the filter (G).
- Leave the filter and container drying completely.
- Verify the washer (H) is in good conditions. Set the sediment container and fuel filter back in place.

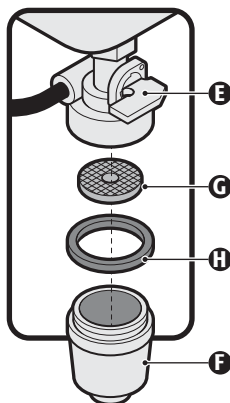

Fuel Drain

- Set under the tank and adequate container to receive gasoline. Use a funnel to prevent fuel from spilling.
- Having the fuel tap closed, remove and clean the fuel filter as indicated in page 11.
- Before setting the filter, open the fuel tap to drain all the fuel tank contents. Once drained, set the filter and sediment container.
- Set under the tank and adequate container to receive gasoline. Use a funnel to prevent fuel from spilling.
- Remove the drain bolt (D).
- Once the fuel is drained in the container, set the drain bolt back and washer. Tighten firmly.
- Clean all fuel.

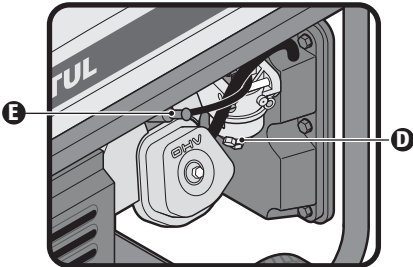

Spark Plug

- Before removing the spark plug (E) clean the area around the spark plug base to prevent dust and debris entering the motor. Then, remove the spark plug with the wrench included.
- Clean the carbon deposits from the spark plug electrode. Use a spark plug cleaner or a wire brush.
- If the spark plug is damaged or worn, or reusing it is doubtful, replace with an identical one.
- Measure the gap existing between the two electrodes. Use a spark plug gauge. The distance between the center electrode and the lateral electrode shall measure between 0.02" and 0.03"
- Check the spark plug washer is in good condition. Insert the spark plug manually to prevent a misadjusted position.
- After setting the spark plug, adjust with a spark plug spanner to compress the washer.

CAUTION If you're installing a new spark plug, tighten it until it's half a turn after the spark plug is in place and the washer can be compressed. If you're installing a used spark plug tighten it until it's 1/8 to 1/4 of a turn after the spark plug is in place and the washer can be compressed.

WARNING Improperly installed or out of range spark plugs, can get overheated and will damage the motor.

Storing and Transportation

- When moving the generator, turn **OFF** the engine switch and close the fuel valve. Keep the generator leveled to prevent fuel from spilling
- When storing the generator for long periods of time:
- Drain completely all the fuel of the generator as indicated before. Then, start the motor until all the fuel is eliminated from inside the motor.
- Replace oil as indicated in page 11.
- Remove the spark plug and pour a capful of SAE 10 W-30 oil in the cylinder. Pull the jack-line in the starter to distribute the oil through the system. Then set the spark plug.
- Slowly pull the starter handle until feeling resistance. It indicates the cylinder is reaching the compression phase and the exhaust and absorption valves are closed. Storing the generator under these conditions prevents internal corrosion.
- Clean the generator with a damp cloth and cover it to prevent dust entering and build up.
- Store the generator in a clean, dry place away from children's reach.

Accessories and replacement parts

Replacement	Code	Item	Description
	28214	CB-GEN-70P	Carburador para generador a gasolina GEN-70P
	28213	CB-GEN-55P	Carburador para generador a gasolina GEN-55P

Problem	Cause	Solution
The motor is not starting.	<ul style="list-style-type: none"> • The switch is OFF. • Not enough fuel. • Devices connected to the generator. • Gasoline does not reach the carburetor. • There is no spark in the spark plug. 	<ul style="list-style-type: none"> • Turn the switch ON. • Fill the fuel tank. • Disconnect all devices from the connection panel before starting the generator motor. • Having the fuel tank full, verify the fuel flow to the carburetor: <ol style="list-style-type: none"> 1. Place an appropriate container underneath the carburetor to catch gasoline and use a funnel to prevent fuel from splashing. 2. Remove the drain bolt. Fuel shall flow freely. Otherwise, go to a TRUPER Authorized Service Center. • Make sure the generator is placed on a level surface, check the oil level, and ensure that it falls within the range marked between the minimum and maximum levels in the oil dipstick. • Verify spark in the spark plug: <ol style="list-style-type: none"> 1. Disconnect the spark plug cable. Clean the dust around the spark plug and remove it. 2. Connect the cable to the spark plug. 3. Turn ON the motor switch. 4. Make contact with the lateral electrode of the spark plug with any metallic part of the motor that is free of oil. ⚠ CAUTION It is important to carry out the test in a well-ventilated area and with no fuel spilled, otherwise it could cause an explosion. 5. Pull the jack-line to generate a spark in the space between the spark plug center electrode and the lateral electrode. 6. If there is no spark with the new spark plug, go to a TRUPER Authorized Service Center.
The motor starts but stops unexpectedly.	<ul style="list-style-type: none"> • The oil level is too low. 	<ul style="list-style-type: none"> • Check oil level in the motor as indicated in page 8. Start the motor one more time.
There is no current in the connection panel outlets.	<ul style="list-style-type: none"> • The overload protector has not been reestablished. • Some of the devices connected are not working. 	<ul style="list-style-type: none"> • Verify the thermal protection is ON.
The generator has no voltage.	<ul style="list-style-type: none"> • Damaged overload protection. 	<ul style="list-style-type: none"> • Check the status of the devices before connecting. Repair any damaged device before using it with the generator. • Go to a TRUPER Authorized Service Center to replace it.

In the event of any problem contacting a TRUPER Authorized Service Center, please see our webpage WWW.TRUPER.COM to get an updated list, or call our toll-free numbers 800 690-6990 or 800 018-7873 to get information about the nearest Service Center.

AGUASCALIENTES **DE TODO PARA LA CONSTRUCCIÓN**
GRAL. BARRAGÁN #1201, COL. GREMIAL, C.P. 20050,
AGUASCALIENTES, AGS. TEL.: 449 994 0537

BAJA CALIFORNIA **SUCURSAL TIJUANA**
AV. LA ENCANTADA, LOTE #5, PARQUE INDUSTRIAL EL
FLORIDO II, C.P. 22244, TIJUANA, B.C.
TEL.: 664 969 5100

BAJA CALIFORNIA SUR **FIX FERRETERÍAS**
FELIPE ÁNGELES ESQ. RUIZ CORTÍNEZ S/N, COL. PUEBLO
NUEVO, C.P. 23670, CD. CONSTITUCIÓN, B.C.S.
TEL.: 613 152 1115

CAMPECHE **TORNILLERÍA Y FERRETERÍA AAA**
AV. ÁLVARO OBREGÓN #324, COL. ESPERANZA
C.P. 24080 CAMPECHE, CAMP. TEL.: 981 815 2808

CHIAPAS **FIX FERRETERÍAS**
AV. CENTRAL SUR #27, COL. CENTRO, C.P. 30700,
TAPACHULA, CHIS. TEL.: 962 118 4083

CHIHUAHUA **SUCURSAL CHIHUAHUA**
AV. SILVESTRE TERRAZAS #128-11, PARQUE INDUSTRIAL
BAFAR, CARRETERA MÉXICO CUAUHTÉMOC, C.P. 31415,
CHIHUAHUA, CHIH. TEL.: 614 434 0052

MEXICO CITY **FIX FERRETERÍAS**
EL MONSTRUO DE CORREGIDORA, CORREGIDORA # 35,
COL. CENTRO, C.P. 06060, CUAUHTÉMOC, CDMX.
TEL.: 55 5522 5051 / 5522 4861

COAHUILA **SUCURSAL TORREÓN**
CALLE METAL MECÁNICA #280, PARQUE INDUSTRIAL
ORIENTE, C.P. 27278, TORREÓN, COAH.
TEL.: 871 209 68 25

COLIMA **BOMBAS Y MOTORES BYMTESA DE MANZANILLO**
BLVD. MIGUEL DE LA MADRID #190, COL. 16 DE
SEPTIEMBRE, C.P. 28259, MANZANILLO, COL.
TEL.: 314 352 1986 / 352 8013

DURANGO **TORNILLOS ÁGUILA, S.A. DE C.V.**
MAZURIO #200, COL. LUIS ECHEVERRÍA, DURANGO,
DGO. TEL.: 618 817 1946 / 618 818 2844

ESTADO DE MÉXICO **SUCURSAL CENTRO JILOTEPEC**
PARQUE INDUSTRIAL # 1, COL. PARQUE INDUSTRIAL
JILOTEPEC, JILOTEPEC, EDO. DE MÉX. C.P. 54257
TEL.: 761 782 9101 EXT. 5728 Y 5102

GUANAJUATO **CÍA. FERRETERA NUEVO MUNDO S.A. DE C.V.**
AV. MÉXICO - JAPÓN #225, CD. INDUSTRIAL, C.P. 38010,
CELAYA, GTO. TEL.: 461 617 7578 / 79 / 80 / 88

GUERRERO **CENTRO DE SERVICIO ECLIPSE**
CALLE PRINCIPAL MZI LT. 1, COL. SANTA FE, C.P. 39010,
CHILPANCINGO, GRO. TEL.: 747 478 5793

HIDALGO **FERREPRECIOS S.A. DE C.V.**
LIBERTAD ORIENTE #304 LOCAL 30, INTERIOR DE PASAJE
ROBLEDO, COL. CENTRO, C.P. 43600, TULANCINGO,
HGO. TEL.: 775 753 6615 / 775 753 6616

JALISCO **SUCURSAL GUADALAJARA**
AV. ADOLFO B. HORN # 6800, COL: SANTA CRUZ DEL
VALLE, C.P.: 45655, TLAJOMULCO DE ZUÑIGA, JAL.
TEL.: 33 3606 5285 AL 90

MICHOACÁN **FIX FERRETERÍAS**
AV. PASEO DE LA REPÚBLICA #3140-A, COL.
EX-HACIENDA DE LA HUERTA, C.P. 58050, MORELIA,
MICH. TEL.: 443 334 6858

MORELOS **FIX FERRETERÍAS**
CAPITÁN ANZURES #95, ESQ. JOSÉ PERDIZ, COL.
CENTRO, C.P. 62740, CUAUTLA, MOR.
TEL.: 735 352 8931

NAYARIT **HERRAMIENTAS DE TEPEC**
MAZATLAN #117, COL. CENTRO, C.P. 63000, TEPEC, NAY.
TEL.: 311 258 0540

NUEVO LEÓN **SUCURSAL MONTERREY**
CARRETERA LAREDO #300, 1B MONTERREY PARKS,
COLONIA PUERTA DE ANÁHUAC, C.P. 66052, ESCOBEDO,
NUEVO LEÓN, TEL.: 81 8352 8791 / 81 8352 8790

OAXACA **FIX FERRETERÍAS**
AV. 20 DE NOVIEMBRE #910, COL. CENTRO, C.P. 68300,
TUXTEPEC, OAX. TEL.: 287 106 3092

PUEBLA **SUCURSAL PUEBLA**
AV. PERIFÉRICO #2-A, SAN LORENZO ALMECATLA,
C.P. 72710, CUAUTLACINGO, PUE.
TEL.: 222 282 8282 / 84 / 85 / 86

QUERÉTARO **ARU HERRAMIENTAS S.A. DE C.V.**
AV. PUERTO DE VERACRUZ #110, COL. RANCHO DE
ENMEDIO, C.P. 76842, SAN JUAN DEL RÍO, QRO.
TEL.: 427 268 4544

QUINTANA ROO **FIX FERRETERÍAS**
CARRETERA FEDERAL MZ. 46 LT. 3 LOCAL 2, COL. EJIDAL,
C.P. 77710 PLAYA DEL CARMEN, Q.R.
TEL.: 984 267 3140

SAN LUIS POTOSÍ **FIX FERRETERÍAS**
AV. UNIVERSIDAD #1850, COL. EL PASEO, C.P. 78320,
SAN LUIS POTOSÍ, S.L.P. TEL.: 444 822 4341

SINALOA **SUCURSAL CULIACÁN**
AV. JESUS KUMATE SUR #4301, COL. HACIENDA DE LA
MORA, C.P. 80143, CULIACÁN, SIN.
TEL.: 667 173 9139 / 173 8400

SONORA **FIX FERRETERÍAS**
CALLE 5 DE FEBRERO #517, SUR LT. 25 MZ. 10, COL.
CENTRO, C.P. 85000, CD. OBREGÓN, SON.
TEL.: 644 413 2392

TABASCO **SUCURSAL VILLAHERMOSA**
CALLE HELIO LOTES 1, 2 Y 3 MZ. #1, COL. INDUSTRIAL,
2A ETAPA, C.P. 86010, VILLAHERMOSA, TAB.
TEL.: 993 353 7244

TAMAULIPAS **VM ORINGS Y REFACCIONES**
CALLE ROSITA #527 ENTRE 20 DE NOVIEMBRE Y GRAL.
RODRIGUEZ, FRACC. REYNOSA, C.P. 88780, REYNOSA,
TAMS. TEL.: 899 926 7552

TLAXCALA **SERVICIOS Y HERRAMIENTAS INDUSTRIALES**
PABLO SIDAR #152, COL. BARRIO DE SAN BARTOLOMÉ,
C.P. 90970, SAN PABLO DEL MONTE, TLAX.
TEL.: 222 271 7502

VERACRUZ **LA CASA DISTRIBUIDORA TRUPER**
BLVD. PRIMAVERA, ESQ. HORTENSIA S/N, COL.
PRIMAVERA C.P. 93508, POZA RICA, VER.
TEL.: 782 823 8100 / 826 8484

YUCATÁN **SUCURSAL MÉRIDA**
CALLE 33 #600 Y 602, LOCALIDAD ITZINCAB Y MULSAY,
MPIO. UMAN, C.P. 97390, MÉRIDA, YUC.
TEL.: 999 912 2451

Codes	Models	Brand
26035	GEN-55P	PRETUL®
26036	GEN-70P	

Warranty. Duration: 1 year. Coverage: parts, components and workmanship against manufacturing or operating defects, except if used under conditions other than normal; when it was not operated in accordance with the instructive; was altered or repaired by personnel not authorized by TRUPER. To make the warranty valid, present the product, stamped policy or invoice or receipt or voucher, in the establishment where you bought it or in Corregidora 35, Centro, Cuauhtémoc, CDMX, 06060, where you can also purchase parts, components, consumables and accessories. It includes the costs of transportation of the product that derive from its fulfillment of its service network. . Phone number 800-018-7873. Made in China. Imported by TRUPER, S.A. de C.V. Parque Industrial 1, Parque Industrial Jilotepec, Jilotepec, Edo. de Méx. C.P. 54257, Phone number 761 782 9100.

Stamp of the business. Delivery date:



